

# LE-2SS Liquid Eliminator



The Welker LE-2SS Liquid Eliminator is designed to protect analyzers from damage and contamination by removing liquids from gas samples.

## Features

- Integrated liquid and sediment filtration
- Liquid-eliminating chamber
- Self-draining design
- Optional Knock-Out Probe™ for pipeline mount
- Stainless steel construction

## Benefits

- Optimizes profitability by protecting sensitive equipment from liquid damage
- Quick and easy installation
- Simple maintenance



Optional Knock-Out Probe™

Product and/or components are manufactured under US Patent: 6,764,536

## SPECIFICATIONS

LE-2SS LIQUID ELIMINATOR

### LE-2SS

Materials of Construction	304 Stainless Steel, 316/316L Stainless Steel, Copolymer Filter Element, Teflon®, Viton®
Inlet Connection	¼" FNPT
Outlet Connection	¼" FNPT
Pipeline Connection	¾" MNPT (Knock-Out Probe™ Option)
Insertion Length	8" (Knock-Out Probe™ Option)
Operating Pressure	1440 psig @ -20 °F to 100 °F

# STANDARD OPTIONS

LE-2SS LIQUID ELIMINATOR

## LE2SS FOR STAND-ALONE LIQUID ELIMINATOR

WITH OPTIONAL KNOCK-OUT PROBE™

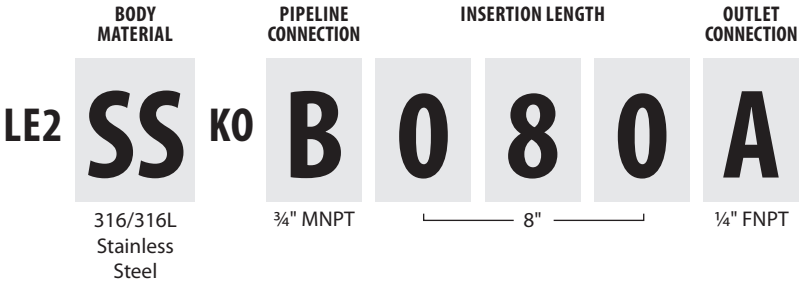

For custom options, choose **Plus Welker™**.



*Customer Inspired. Welker Manufactured.*

Collaborate with us to create a custom product unique to your application.

## DIMENSIONS

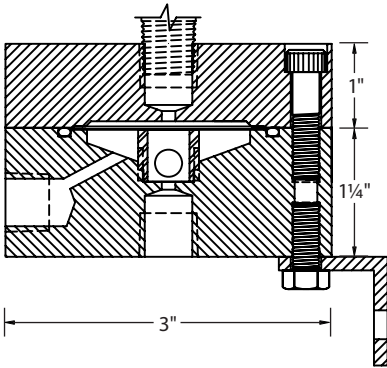

LE-2SS

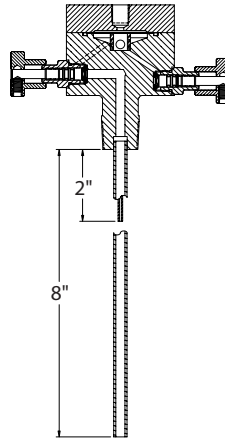

LE-2SS  
With Knock-Out Probe™

Weight and/or dimensions are approximate.  
Specifications subject to change without notice.

